

Steam Steriliser

Instruction Manual & Guarantee

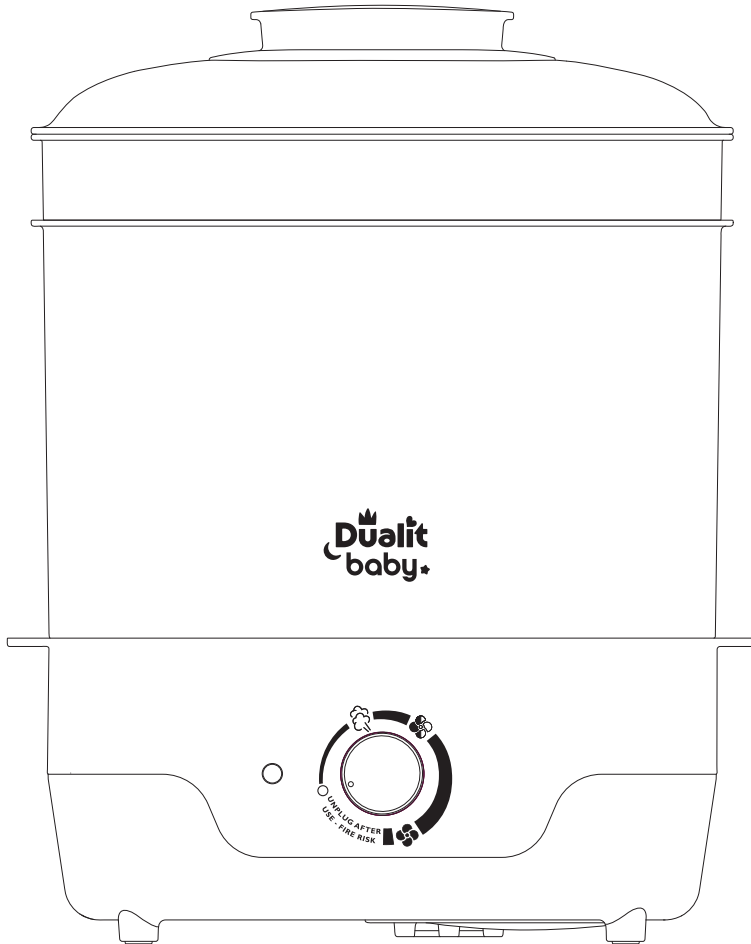

DON'T FORGET
TO REGISTER
YOUR PRODUCT

WWW.DUALIT.COM/REGISTER

OR BY POST



Register ✓
my appliance

DUALIT BABY RANGE

Dualit has been making high quality, innovative products to make the lives of our customers easier for over 75 years. The Dualit Baby range includes the essential products parents need to feed their baby safely and easily and true to the Dualit ethos, are functional and fuss-free. Welcome to the Dualit family.

The Dualit Steam Steriliser has four steaming and drying options and will sterilise up to six bottles in as little as 15 minutes. For your peace of mind, the sterilising cycles kill 99.9% of harmful bacteria.

REGISTER YOUR PRODUCT

- 1. Fast and efficient customer service** important safety advice, access to manuals and product information should you require assistance with your purchase.
- 2. A library of mouth-watering recipes** and regular articles and blogs.
- 3. Be the first to hear** about exciting new Dualit products.

Dualit recommends safety first: please register your product so that we can contact you in the unlikely event that a safety notification is issued. Remember to keep your receipt as proof of purchase.

DON'T FORGET
TO REGISTER
YOUR PRODUCT

WWW.DUALIT.COM/REGISTER

OR BY POST



Register ✓
my appliance

CONTENTS

Safety precautions _____	04
Know your Steam Steriliser _____	06
Functions _____	07
Setting Up _____	08
Filling Your Steriliser _____	09
Using Your Steriliser _____	10
Cleaning and Care _____	13
Cleaning The Filter _____	14
Descale Regularly _____	15
Troubleshooting _____	16
Guarantee _____	18

Unpack the box with care, keeping all the packaging materials until you are satisfied everything is present and in working order. Once satisfied remove any tags from the appliance body and recycle the packaging appropriately. Do not remove tags from the cord. You may wish to keep the box to store your appliance.

All illustrations are for representation only; your model may vary from illustrations shown.



IMPORTANT SAFETY PRECAUTIONS



READ ALL INSTRUCTIONS

BEFORE USING THE STERILISER KEEP THESE INSTRUCTIONS FOR FUTURE REFERENCE.

IMPORTANT SAFEGUARDS

• THIS IS AN ATTENDED APPLIANCE.

Do not leave unattended during use, unplug after each use (risk of fire if an unattended appliance is left operating or plugged in).

- This appliance must not be used by children younger than 8 years old and persons with very extensive and complex disabilities. Children aged 8-14 years and persons with reduced physical, sensory or mental capabilities or lack of experience and knowledge shall not use this appliance, unless they are supervised and have been given instruction concerning the use of the appliance in a safe way and understand the hazards involved. Children shall not play with the appliance.
- Cleaning and user maintenance shall not be made by children unless they are older than 8 and supervised. Keep the appliance and its cord out of reach of children less than 8 years old.
- Appliances can be used by persons with reduced physical, sensory, or mental capabilities or lack of experience and knowledge if they have been given supervision or instruction concerning use of the appliance in a safe way and understand the hazards involved.
- This appliance is intended for household use only. If the appliance is used improperly or for professional or semi-professional purposes or if it is not used according to these instructions the Guarantee becomes invalid and Dualit refuses any liability for damage caused.

Before Connecting to the Mains Supply

- Check that the voltage marked on the appliance corresponds with the supply voltage.

- Note: any plug cut from the power supply cord should be disposed of immediately. Inserting any cut off plug into a 13A socket-outlet is hazardous.
- Never use the plug without the fuse cover fitted. Ensure replacement fuse is the same current value as the original. Replacement fuses are available and should be ASTA approved to BS1362.
- We recommend that the appliance is plugged into a socket that has no other appliance connected to it. Failure to do this may cause an overload, trip a circuit breaker, or blow a fuse. Preferably the socket outlet should be protected by a residual current device (RCD).
- This appliance conforms to directive 2014/30/EU regarding electromagnetic compatibility.
- Should the light remain illuminated after using the appliance, immediately unplug the appliance and call service centre. **Risk of fire and electric shock.**
- Do not place the appliance or mains lead on or near any hot surface, hot hob, gas burner or in a heated oven.
- To be protected against electrical hazards, fire, and injury to persons, do not immerse the mains lead, plug or appliance in water or any other liquid. **Risk of electric shock.**
- Do not operate any appliance with a damaged lead or plug, or after the appliance malfunctions or has been dropped, damaged, or cracked in any manner.
- In order to avoid a hazard, if the power cord is damaged it must, for safety reasons, be replaced by Dualit or an authorised Dualit repairer. Call Dualit's Customer Helpline on +44 (0)1293 652 500.
- A short power-supply cord is provided to reduce risks resulting from becoming entangled in or tripping over a longer cord.
- Do not allow cable to hang over the edge of a table or countertop.
- Do not fill above the 'max' mark on the water level indicator. **Risk of fire and electric shock.**
- Do not operate on an uneven surface. The

machine must only be operated on a flat, horizontal surface.

- Do not use in bathroom or outdoors. If it is not used according to these instructions the Guarantee becomes invalid and Dualit refuses any liability for damage caused.
- Do not store or use in an appliance garage or under cupboards. **Risk of fire.**
- Ensure that the appliance is assembled with all components in place before switching on.
- Do not move the appliance while it is switched on.
- Do not remove or open the lid while appliance is switched on.
- Do not remove items from the appliance while it is switched on.
- **Caution:** Product surface, Heating Element and appliance interior is subject to residual heat after use. **Risk of scalding.**
- **Warning:** Do not place items in the Water Recess or on the Element; risk of fire. Only place items to be sterilised on the racks provided.
- Use handles or knobs – do not touch hot surfaces.
- **Hot Water Hazard.** Avoid direct contact with hot water. Unplug the appliance from the mains to allow to cool before cleaning, maintaining, moving, or storing. For details, please refer to cleaning section.
- **Warning - steam hazard:** When boiling, hot steam will be emitted from the appliance. Scalding may occur if you are within 400mm of the steam vent.
- Scalding may occur if the lid is opened during the boiling cycle.
- **Caution:** vents are hot risk of scalding.
- This appliance features boil-dry protection. If the appliance overheats, the boil-dry device will switch off the heating element to prevent damage to the appliance. Wait approximately ten minutes for

the appliance to cool down, and refill as normal. The appliance is now ready to use again. **Note: if discolouration of the heating plates has occurred, this can be easily removed by descaling your appliance.**

- Unplug the appliance from the wall socket when not in use, or before moving and cleaning.
- To disconnect, turn any control to off, then remove plug from wall outlet.
- **Caution:** to prevent damage to the appliance, do not use alkaline cleaning agents. When cleaning, use a soft cloth and a mild detergent.
- Do not use scouring pad or abrasive cleaner on the appliance body.
- Never operate the appliance with a blocked filter or without the filter. **Risk of fire.**
- Always pour any remaining water out of the appliance after use, after the appliance has cooled down and has been unplugged. Pour water away from the Air Vents. **Risk of fire and electric shock.**
- The use of accessory attachments is not recommended by Dualit and may result in fire, electric shock, or injury to persons.

Descal Regularly

- **Do not operate the appliance if filled with descaling solution. This can cause damage to the machine and burning / scalding risk to user.**

SAVE THESE INSTRUCTIONS

In the interest of improving products, Dualit Ltd. reserves the right to change the product specification

Unpack the box with care, keeping all the packaging materials until you are satisfied everything is present and in working order. Once satisfied remove any tags from the appliance body and recycle the packaging appropriately. Do not remove tags from the cord. You may wish to keep the box to store your appliance.



KNOW YOUR STEAM STERILISER

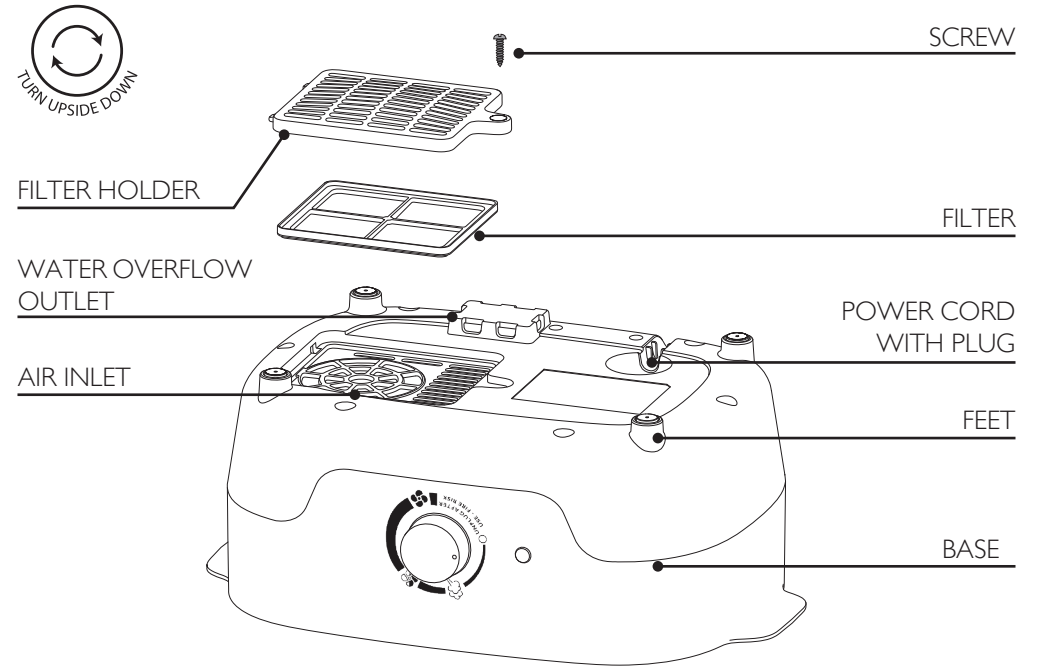
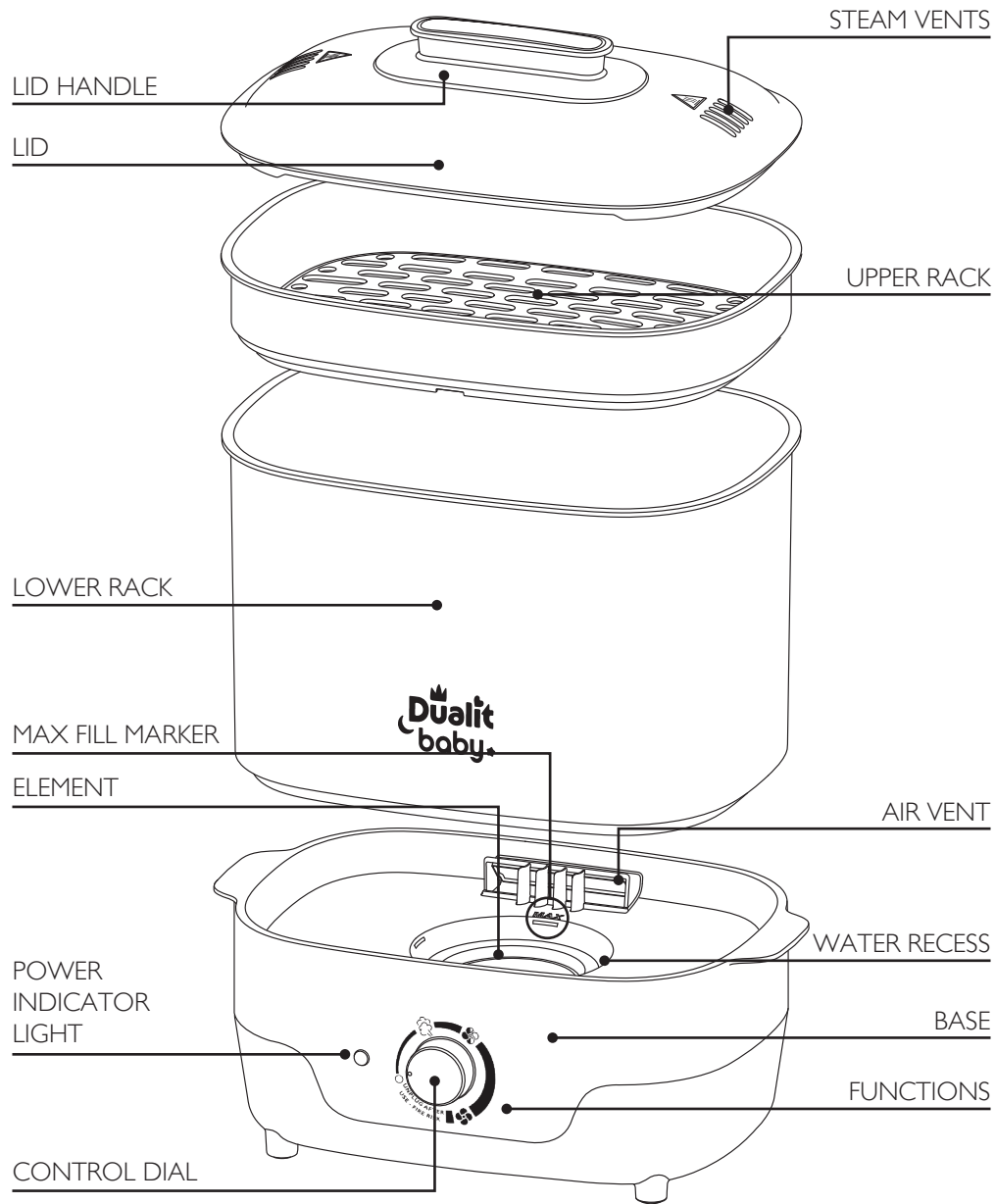

FUNCTIONS

ICON	FUNCTION	DESCRIPTION
	Sterilise Only	Sterilise up to 6 full bottles. This function kills 99.9% of bacteria.*
	Sterilise and Quick Dry	Sterilise and dry up to 6 bottles in 30 minutes. Ideal for immediate use or when not fully loaded with items. Items may not be completely dry. This function kills 99.9% of bacteria.*
	Sterilise and Dry	Sterilise and dry up to 6 bottles in 60 minutes. Items will be completely dry and ready to use or store for later use. This function kills 99.9% of bacteria.*
	Dry Only	Dry up to 6 bottles in 30 minutes by turning the control dial to Sterilize and Quick Dry. There must be no water in the Water Recess for this function.

*Bottles will be sterile for 24 hours after cycle as long as the lid isn't removed.

Note: Your Steriliser has a built-in filter. This can be removed for cleaning. In the interest of improving products, Dualit Ltd. reserves the right to change the product specification without prior notice. All illustrations are for representation only, your model may vary from illustrations shown.

SETTING UP

Read and follow these instructions before using your Steriliser. **THIS IS AN ATTENDED APPLIANCE.** Do not leave unattended during use, unplug after each use (risk of fire if an unattended appliance is left operating).



Never remove the Lid while the Steriliser is operating (Power Indicator Light is illuminated). This will cause a failure to sterilise. Please wait 5 minutes for the Steriliser to cool before removing the Lid. **Warning: Hot water and steam may cause serious injury and burns; keep hands away from hot surfaces and steam vents. Risk of scalding.**

Before first use, wash the Upper and Lower Racks and the Lid with warm soapy water and rinse thoroughly. Do not submerge the Base, Power Cord or Plug as there is a risk of electric shock and permanent damage to the appliance.



Register your product at Dualit.com this will only take 60 seconds; you will need the product model and serial number which is on the rating label on the base of the product.

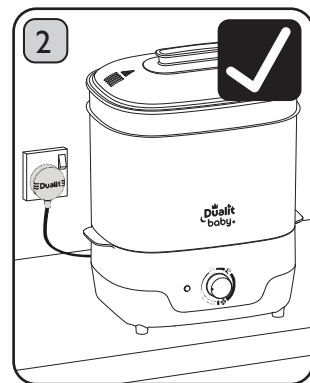

Position the Steriliser on a flat surface away from sources of heat. Place the Steriliser as close to the wall socket as possible. **Do not store or use the Steriliser in an appliance garage or under cupboards, close to curtains or flammable material as the Steriliser will emit steam from the Steam Vents in the Lid. Do not cover vents, covering vents causes risk of fire.**

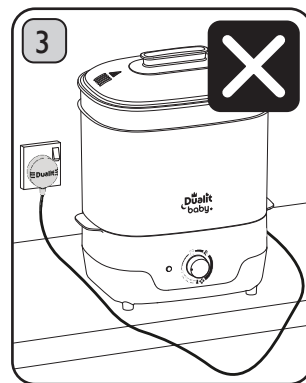

Ensure that the Steriliser is placed on a heat resistant work surface. Do not operate on a tray. Do not let the cord hang over the edge of work surfaces or touch hot surfaces.

USING YOUR STERILISER



Before first use or after a long period of no use, fill and then operate your Steriliser empty with no bottles on a Sterilise function (Steps 1-15 below).

It is important that all bottles, teats and accessories are empty, separated and that they are thoroughly cleaned using soap suds and rinsed in fresh water before placing in the Steriliser for sterilisation.

Warning: The Steriliser is only suitable for high temperature-resistant bottles and items that can withstand a temperature of 100°C.

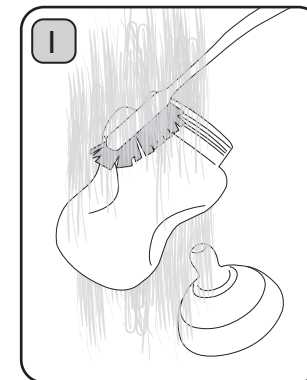

Clean and rinse bottles, dummies and teats before sterilising.

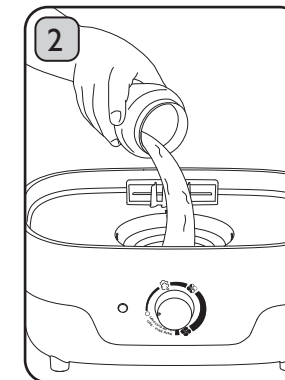

Pour exactly 90ml of fresh tap water into the Water Recess. Do not exceed the max marker. You can use demineralised water if you want to reduce the number of times you need to descale.

Warning: Only operate with 90ml of water and do not over fill. Ensure water is not spilled or poured into the Air Vent area. Never use less than 90ml of water as sterilisation will not complete, risk of bacterial or viral contamination. Tip - You can use a baby bottle as a measuring device or weigh 90g of water.

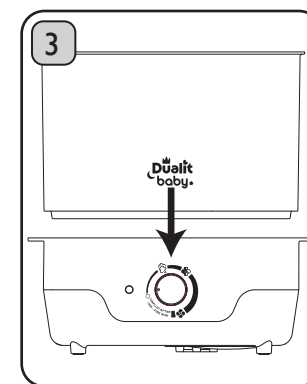

After filling your Steriliser with 90ml of water, place the Lower Rack into position. Ensure Lower Rack is positioned correctly with logo facing forward. **Warning: The appliance will not sterilise if Lower Rack is incorrectly positioned.**

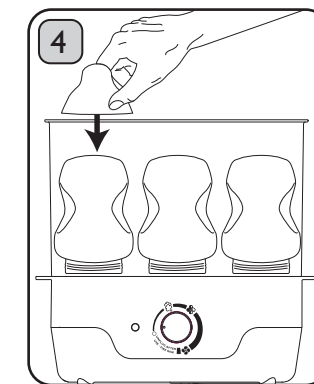

Position baby bottles on the Lower Rack facing downwards with the necks over the locators. Place the bottle lids over the bases of the bottles. **Notes: The Steriliser can accommodate a maximum of 6 bottles at a time.**

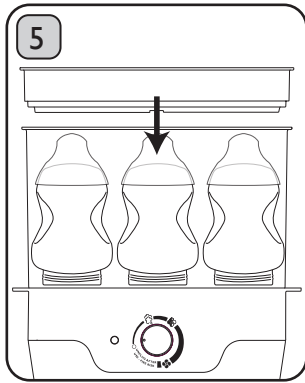

Put the Upper Rack into position on top of the Lower Rack.

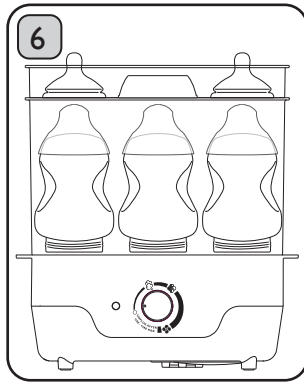

Place the bottle teats, collars and accessories on the Upper Rack. Ensure teats face upwards, so that they do not collect water / condensation.

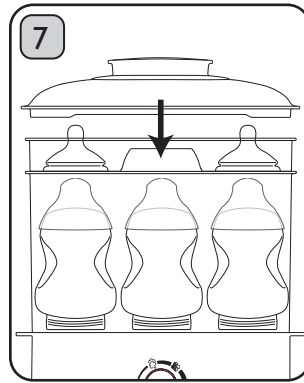

Place the Lid into position. **Caution: Failure to locate lid will prevent sterilisation. Risk of bacterial and viral contamination.**

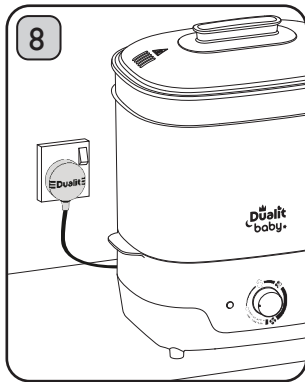

Plug in the Power Cord at the mains.

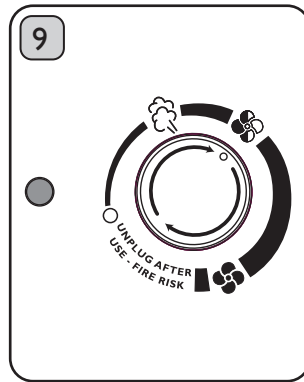



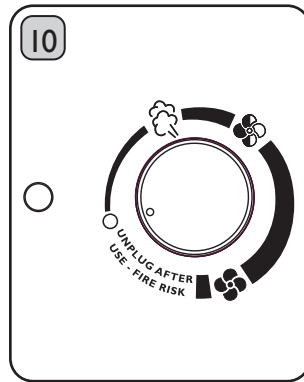

Turn the Control Dial to the function that you wish to use. The Power Indicator Light will illuminate. (see table below).



When the cycle has finished, the Control Dial will be in the 'O' position and the Power Indicator Light will NOT be illuminated. **If light remains illuminated after use immediately isolate the Steriliser & call service centre.**

Warning: Do not place items in the Water Recess or on the Element; risk of fire. Only place items to be sterilised on the racks provided.

FUNCTION	DESCRIPTION	TIME
	Sterilise up to 6 full bottles. This function kills 99.9% of bacteria. Note: This function requires 90ml of water; more than 90ml of water will prolong the sterilisation cycle time, less than 90ml may not sterilise items properly. If you leave the lid on your Steriliser, item will remain sterile for 24 hours.	15 minutes

FUNCTION	DESCRIPTION	TIME
	Sterilise and Quick Dry Sterilise and dry up to 6 bottles in 30 minutes. This function kills 99.9% of bacteria. Ideal for immediate use. Items may not be completely dry. Note: This function requires 90ml of water; more than 90ml of water will prolong the sterilisation cycle time, reducing the drying time. Less than 90ml may not sterilise items properly. If you leave the lid on your Steriliser, item will remain sterile for 24 hours.	30 minutes
	Sterilise and Dry Sterilise and dry up to 6 bottles in 60 minutes. This function kills 99.9% of bacteria. Items will be completely dry and ready to use or store for later use. Note: This function requires 90ml of water; more than 90ml of water will prolong the sterilisation cycle time, reducing the drying time. Less than 90ml may not sterilise items properly. If you leave the lid on your Steriliser, item will remain sterile for 24 hours.	60 minutes
	Dry Only Dry up to 6 bottles in 30 minutes by ensuring the water recess is empty and turning the control dial to Sterilize and Quick Dry. Without water this function will dry items that have been sterilised only and are still wet, or dry any items that require a longer drying cycle.	30 minutes

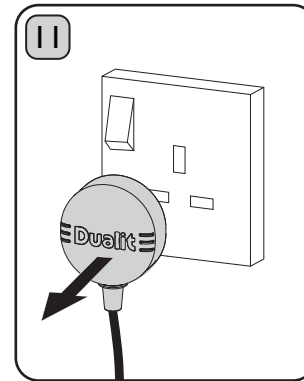

Unplug the Steriliser from the mains. **Caution: After the Power Indicator Light has gone out wait 5 minutes before opening the lid. Caution: The Steriliser will be hot.**

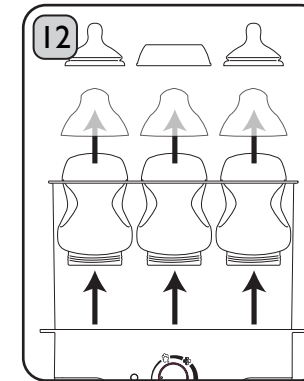

Wash hands for 20 seconds with soap. Remove the milk bottles and other items carefully from the Upper and Lower Racks. **Caution: The sterilised items may still be hot. We recommend that you use tongs to handle the sterilised items.**



Warning: Allow 10 minutes before starting another cycle.

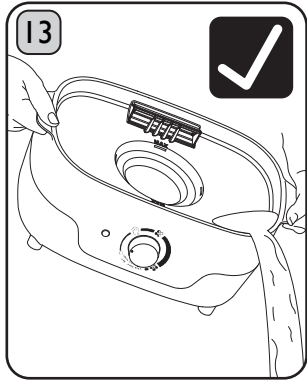

If any water is left in the Steriliser after use, pour away and replace with fresh water before starting a new sterilising cycle. Caution: Pour water towards a front corner to ensure that no water goes into the Air Vent. Risk of fire and electric shock.

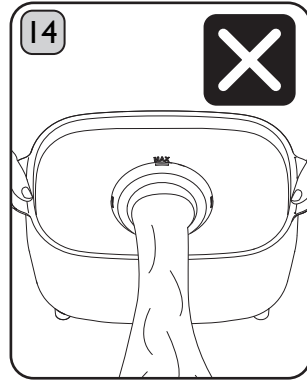

Do not pour unused or excess water out at any other angle.

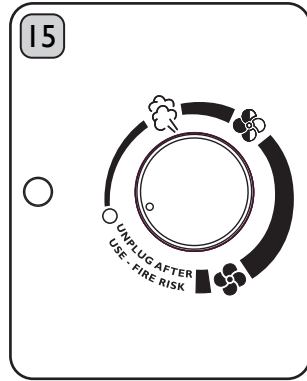

If you wish to turn the Steriliser off during a sterilisation cycle, turn the Control Dial to "O" setting and unplug.

The Steriliser needs to cool down after a function cycle before it can be used again for a new sterilising process.

Note: If you leave the lid on your Steriliser the items will remain sterilised for up to 24 hours. The Steriliser needs to cool down for 10 minutes after a function cycle before it can be used again for a new sterilising process.

Warning: If you turn off the sterilisation cycle before it finishes, the items will not be sterile.

CLEANING & CARE

Before cleaning make sure the appliance is switched off, unplugged and allowed to cool. Dualit recommends cleaning your Steriliser regularly.

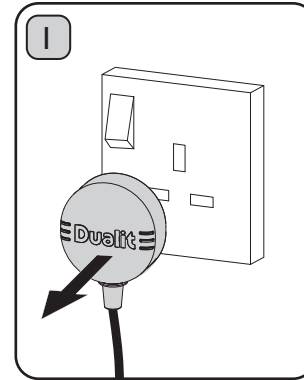

Unplug the Steriliser from the mains and allow to cool down completely before cleaning.

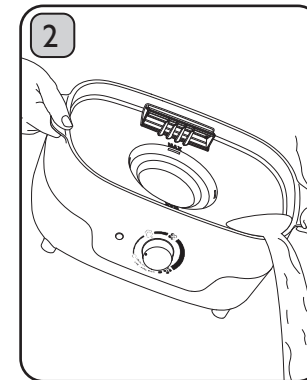

Over a sink, pour away any water remaining in the Water Recess. **Note: Pour water towards a front corner to ensure that no water goes into the Air Vent. Risk of fire and electric shock.**



Clean all surfaces of the Upper Rack, Lower Rack, and Lid with mild detergent (washing up liquid) and a soft, damp cloth. **Note: Do not use sharp, abrasive or aggressive cleaning agents, bleach, or scouring pads to clean the Steriliser. The use of such cleaning implements may affect the life of the Steriliser.**



Wipe the external surfaces of the Base with mild detergent (washing up liquid) and a soft, damp cloth. Note: Do not submerge in water and ensure no water goes into the Air Vent. Do not use sharp articles or metal tools to touch the Element as it may cause electric shock. Do not submerge the Base, the power cord or the plug in water or other liquid or position under a water tap. Do not use sharp, abrasive or aggressive cleaning agents, bleach, or scouring pads to clean the Steriliser. The use of such cleaning implements may affect the life of the Steriliser. **Note: When not in use clean and dry the Steriliser and store in a cool, dry place.**

DON'T FORGET TO REGISTER YOUR PRODUCT	WWW.DUALIT.COM/REGISTER	Register my appliance ✓
	OR BY POST 	

CLEANING THE FILTER

Clean your Steriliser Filter at least every month.

Caution: A blocked or dirty Filter will affect the Steriliser's performance.

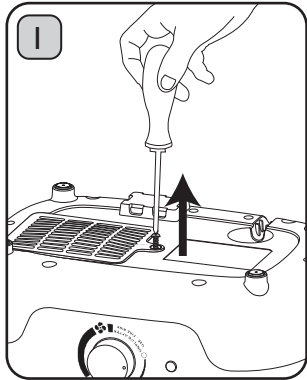

Use a Philips 2 screwdriver to undo the screw holding the Filter Holder into position. Remove Filter.

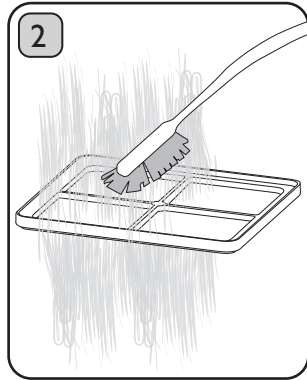

Remove Filter and rinse under a tap while carefully brushing with soap suds and a soft brush or lint-free cloth until all visible dust is removed. **Warning: Do not operate the Steriliser unless the Filter is in position. Risk of fire.**

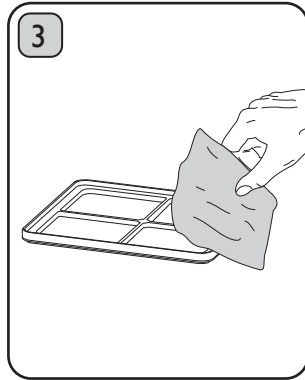

Dry the Filter with a lint-free cloth. Allow to fully dry before replacing in the Steriliser Base.

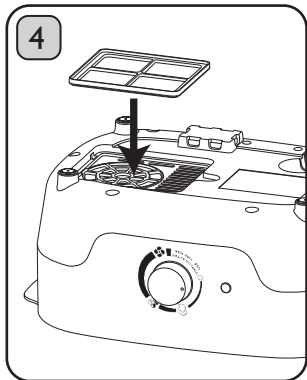

Replace the Filter in the Steriliser Base.

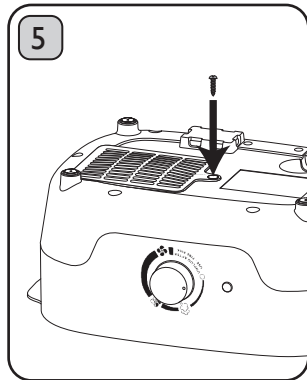

Place the Filter Holder back in position and tighten the screw.

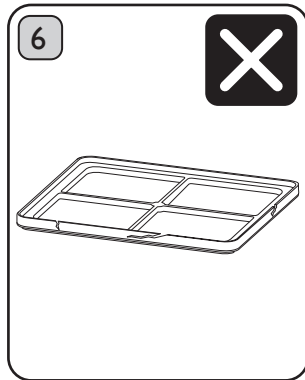

Warning: If filter is torn, cracked or damaged in anyway do not use your Steriliser, risk of fire. Call customer services on 01293 652500 to purchase a replacement.

DESCALE REGULARLY

Important Notice: Product failure due to the build up of limescale is not covered by guarantee.

The Steriliser needs to be descaled regularly. As a minimum it is recommended that you descale your Steriliser once a month in soft water areas, every 21 days in medium water areas and every 14 days in hard water areas. You can check your water hardness with your water provider. **Wear rubber gloves. Do not use on marble surfaces. Do not put descaler bottle down on work surfaces. Wipe descaler bottle after use.**

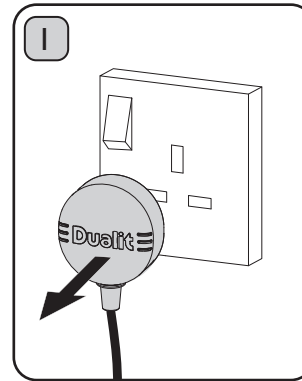

Unplug the Steriliser from the mains and allow to cool down completely before descaling.

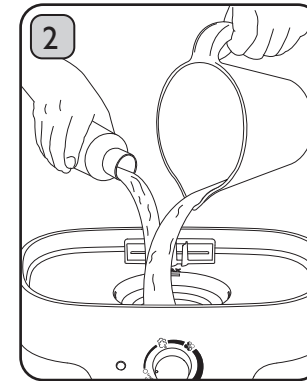

The Steriliser can be descaled by pouring just-boiled water into the Water Recess up to the MAX marker, then adding 30ml of Kilrock Espresso & Coffee Machine Descaler. This can be purchased on www.dualit.com. **Caution: Be aware of splashing. Risk of scalding and chemical inhalation.**

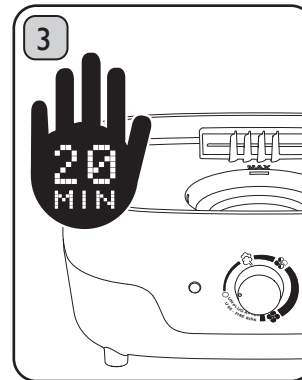

Leave to stand for 20 minutes.

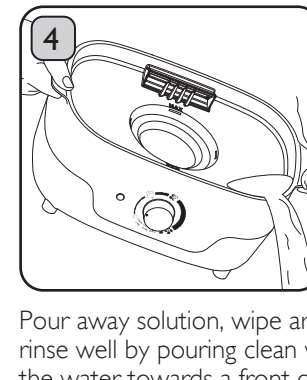

Pour away solution, wipe around the surface with a cloth and rinse well by pouring clean water into the Water Recess. Pour the water towards a front corner to ensure that no water goes into the Air Vent. Rinse the Water Recess a minimum of three times. **Failure to do so can cause injury. Do not operate Steriliser with descaling solution in it. TIP: Follow these few simple steps to minimise limescale build up in your Steriliser: Empty the Steriliser after each use; do not allow water to stand in the Steriliser overnight. Use filtered water instead of tap water.** 15



INSTRUCTIONS ON ENVIRONMENT PROTECTION

Do not dispose of this product in the usual household garbage at the end of its life cycle. Please hand it over to a collection point for the recycling of electrical and electronic appliances. The symbol on the product, the instruction of use or the packaging will inform you about the methods of disposal. The materials are recyclable as mentioned on its marking. By recycling, material recycling or other forms of re-utilization of old appliances you are making an important contribution to protect our environment. Please inquire at the community administration for the authorised disposal location.



TROUBLESHOOTING



POSSIBLE CAUSE(S)	SOLUTION(S)
THE STERILISER DOES NOT TURN ON OR HAS WATER IN THE WATER RECESS AFTER A FUNCTION	
1. The Steriliser needs to cool down after a function cycle before it can be used again for a new sterilising process.	1. The Steriliser has a thermal control to prevent it from overheating - this needs to reset. Wait 10 minutes for the Steriliser to cool down.
2. The Steriliser may not be properly connected to the power supply.	2. Check the plug is in the socket and the switch is turned on.
3. The Steriliser fuse may have failed.	3. Replace the fuse if necessary and check your residual current device (RCD). Never use the plug without the fuse cover fitted. Ensure replacement fuse is the same current value as the original. Replacement fuses are available and should be ASTA approved to BS1362.
4. The Steriliser works but the Power Indicator Light does not illuminate.	4. The Power Indicator Light may have blown and cannot be replaced. Call customer services on 01293 652500 for further information.
THE STERILISER DOES NOT TURN OFF OR IS TAKING LONGER THAN USUAL	
1. The Steriliser Element may have a build-up of limescale. This will show as white and /or brown spots on the Steriliser (Element and Water Recess).	1. Descale your Steriliser regularly, please see Descale section.
2. You may have put too much water into the Steriliser.	2. Ensure you pour the correct amount of water into the Steriliser. Do not fill above the max mark.

POSSIBLE CAUSE(S)	SOLUTION(S)
CONTROL DIAL IS ON 'O', BUT THE POWER INDICATOR LIGHT IS ILLUMINATED	
1. Control dial has developed a fault.	1. Stop using the product. Unplug and Call customer services on 01293 652500 for further information.
THE STERILISER HAS A STRANGE SMELL WHEN I UNPACK IT	
1. Due to the freshness of the materials the Steriliser will produce a slight smell when you take it out of the box.	1. This smell will soon disappear after you have unpacked your Steriliser. We also recommend that you complete one Sterilising process with empty baskets to remove any remaining dirt and smell.
MY STERILISER HAS AN UNPLEASANT SMELL WHEN IN USE	
1. An unpleasant smell can occur when parts are not fully cleaned before placing into the Steriliser.	1. Residue from milk and food may end up on the heating element when the bottles are placed in the Steriliser. The residue can cause an unpleasant smell when the Steriliser is heating up. To avoid this, always clean all parts before Sterilising.
SOME WATER REMAINS ON THE BOTTLES AFTER STERILISATION	
1. If you selected Sterilise or Sterilise and Quick Dry, the bottles will be left with some water residue.	1. If you selected Sterilise or Sterilise and Quick Dry this is normal, if you would like fully dry bottles select Sterilise and Dry.
	2. The Steriliser Filter may need cleaning. Follow the filter cleaning instructions.
	3. If you selected Sterilise and Dry, you may have over filled your Steriliser. Ensure you pour the correct amount of water (90ml) into the Steriliser. Do not fill above the max mark.

GUARANTEE

This appliance is of excellent quality and construction. However, if any defects in materials or workmanship do appear during the relevant guarantee period, we will, at our discretion, either repair or replace the defective parts, free of charge, subject to the terms and conditions of our Guarantee shown below.

This Guarantee covers both parts and labour. Carriage is not included.

Your Guarantee period is as follows:

- 1 year

This Guarantee provides benefits which are additional to, and do not affect, your statutory rights. This Guarantee does not cover the cost of returning the product to the dealer from whom it was purchased or to ourselves. This Guarantee applies only to products sold and located in mainland Great Britain. It does not cover liability in respect of or replacement of plugs, cables or fuses and also does not cover defects due to:

- Failure to use or maintain product in accordance with Dualit's instructions.
- The product being connected to an unsuitable electricity supply.
- Accidental damage to or abuse or misuse of the product.
- Product modification, except by Dualit or approved agent.
- Dismantling of or interference with the product.
- Theft or attempted theft of the product.

Before returning any product under this Guarantee, please check that:

- You have followed the product instructions correctly.
- Your mains electricity supply is functional.
- The defect is not due to a blown fuse.

If you wish to claim under this guarantee you should:

- Send the product, postage or carriage paid, to the dealer from whom it was purchased or to Dualit direct.
- Ensure that the product is clean and packed carefully (preferably in its original carton).
- Enclose details of your name, address and telephone number and when and where the product was purchased, together with proof of purchase (e.g. a till receipt).
- Give exact details of the nature of the defect.

This Guarantee does not cover any other claims whatsoever, including, without limitation, any liability for incidental, indirect or consequential damage, nor does it cover any claims for conversion or modification or for the costs of repair carried out by any third party without the prior consent of Dualit. If replacement parts are fitted to the product this will not extend the period of the Guarantee.

For further advice contact the Dualit customer helpline on +44 (0)1293 652 500 (09:00 to 17:00 Monday to Friday).

Alternatively, email Dualit at info@dualit.com or visit www.dualit.com

Do not throw away the appliance with the normal household waste at the end of its life, but hand it in to an official collection point for recycling. By doing this you help preserve the environment.

DON'T FORGET TO REGISTER YOUR PRODUCT

Take a minute to register your product with us to receive these outstanding benefits:

1 **Fast and efficient customer service** important safety advice, access to manuals and product information should you require assistance with your purchase.

2 **A library of mouth-watering recipes** and regular articles and blogs.

3 **Be the first to hear** about exciting new Dualit products.

Register ✓
my appliance

Dualit recommends safety first: please register your product so that we can contact you in the unlikely event that a safety notification is issued. Remember to keep your receipt as proof of purchase.

WWW.DUALIT.COM/REGISTER



Dualit baby.

A **feeding** and **weaning** range designed to
make everyday baby life that bit **easier**.

ORDER THE FULL RANGE AT
www.dualit.com



Dualit Limited County Oak Way Crawley West Sussex RH11 7ST
+44(0)1293 652 500 info@dualit.com www.dualit.com