

ARCHITECT Kettle panels

Instruction manual

Dualit®

Since 1945



⚠ CAUTION! Edges may be sharp. Use and clean with care.

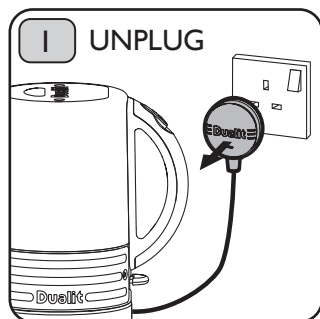

Unplug and empty the kettle. Ensure it has cooled down to room temperature. **Risk of scalding and electric shock.**

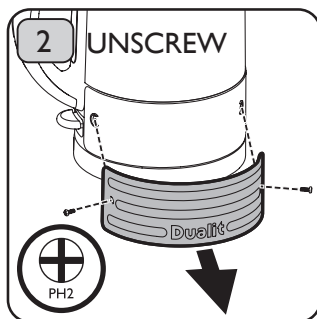

Using a Phillips screw driver (PH2), unscrew and remove the lid and body panels. **NB. Do not operate the kettle with the panels removed.**

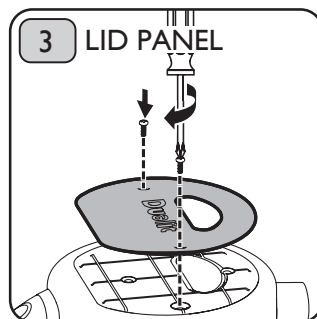

Align the new panel with the screw holes on the lid of the kettle. Loosely screw both screws into position. Tighten to secure.

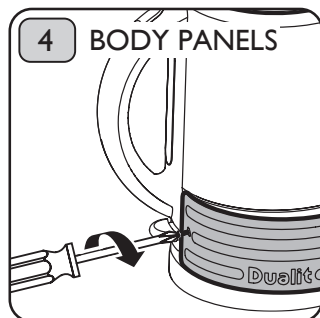

Align the new panel with the screw holes on the body of the kettle and tighten the first screw.

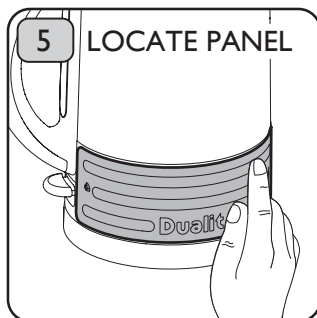

Ensure panel is fully located into recess.

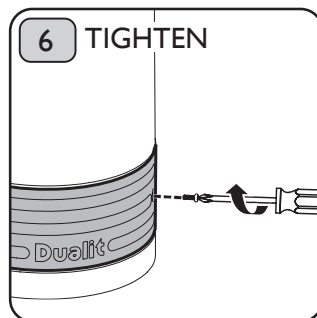

Align and tighten the second screw.

Dualit Limited County Oak Way Crawley West Sussex RH11 7ST

+44(0)1293 652 500 info@dualit.com www.dualit.com



Dualit®

ARCHITECT



You may also like the matching Architect Toaster

www.dualit.com/architect